

1.3 DOUBLE WINDOW VENETIAN BLIND

ReleaseDate 01-A-D01EN.20 Exploded views.fm

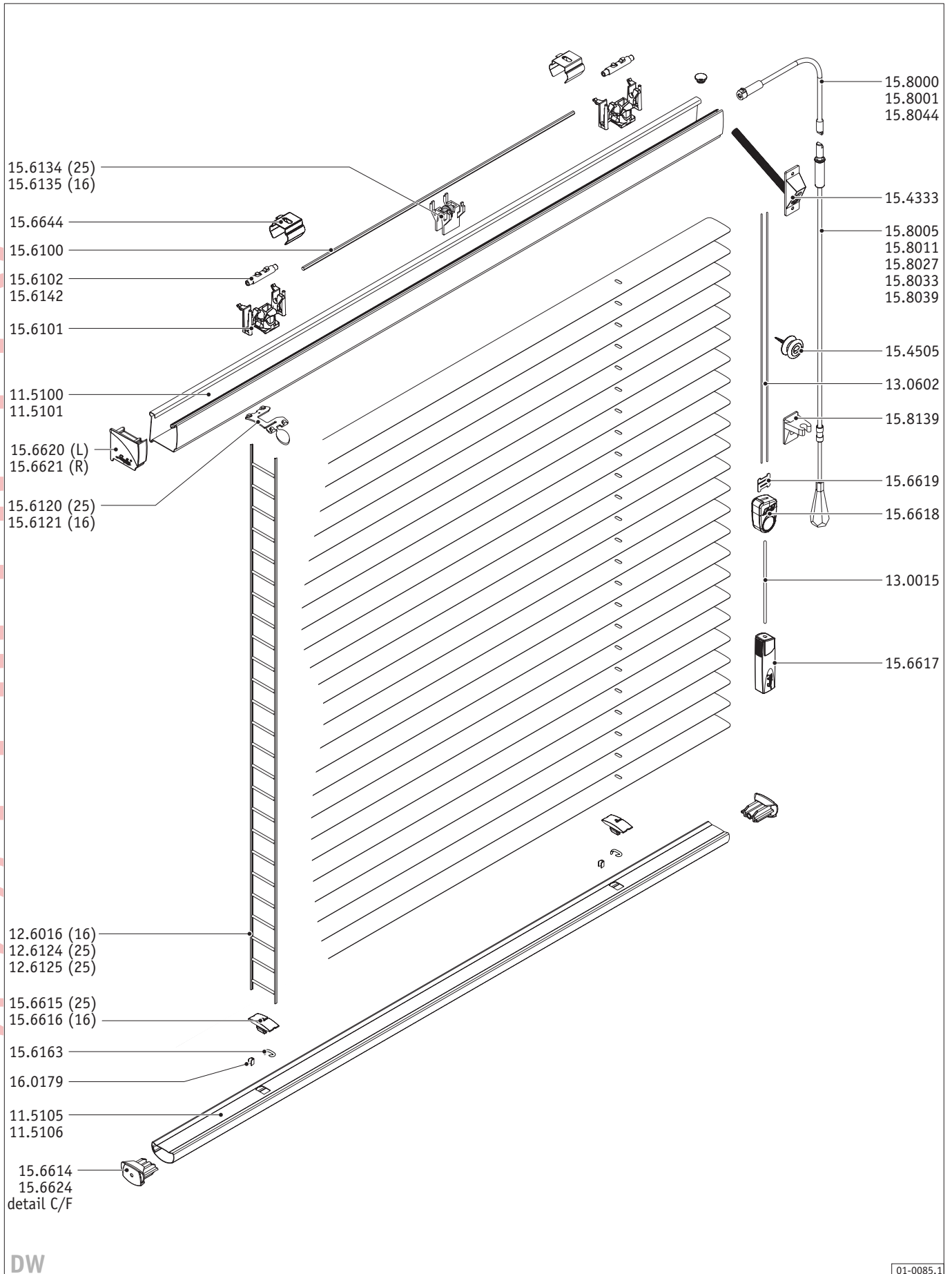

© - 2007 - Hunter Douglas Europe B.V.

1.4 TILT MASTER VENETIAN BLIND

ReleaseDate 01-A-D01EN.20 Exploded views.fm

© - 2007 - Hunter Douglas Europe B.V.

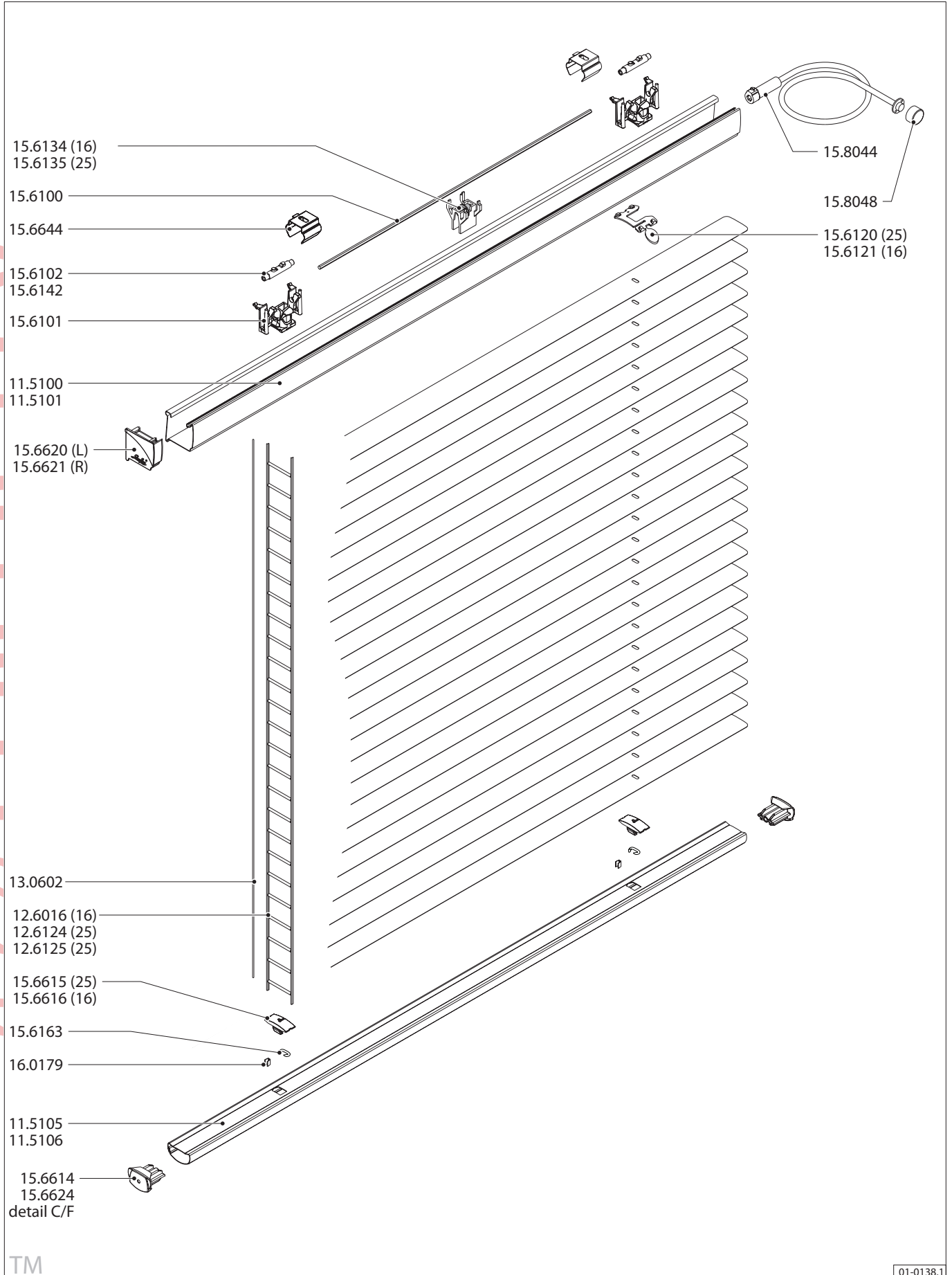

15.5 INSTALLING A DOUBLE WINDOW BLIND

- 1 Drill a $\varnothing 12$ mm feed-through hole in the frame (see figure 15.16).
- 2 De-assemble the torsion rod parts. See chapter 3.4.2, '*Attaching the torsion cable*'.
- 3 De-assemble the cord connector. See chapter 1.4.5, '*Attaching the cord connector and tassel*'.
- 4 Mark off the bracket positions. Bear in mind that the brackets will not interfere with hardware in the head rail and obstacles in the installation area.
- 5 Fasten the brackets.
- 6 Put the cord guide spring in the drilled hole.
- 7 Fasten the cord guide spring.
- 8 Feed the lift cords and torsion rod through the cord guide spring.

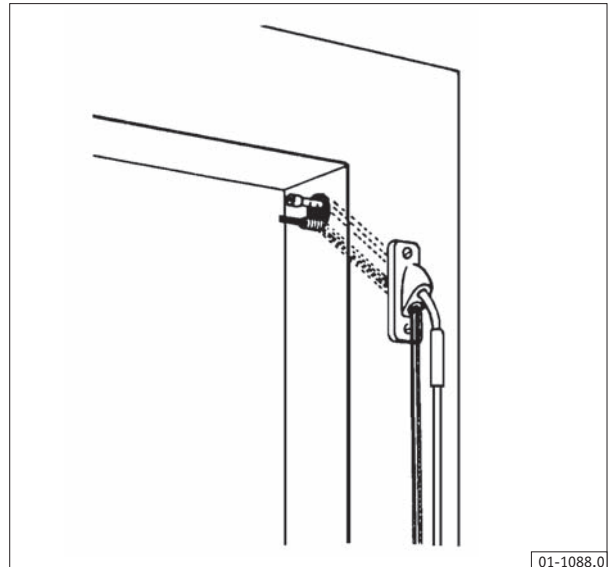

Figure 15.16

- 9 Press the head rail over the brackets.
- 10 Re-assemble the torsion rod parts and the cord connector.
- 11 Fasten the torsion rod bearing at torsion rod ring height [1].
- 12 Press the cord clamp in the window frame [2].

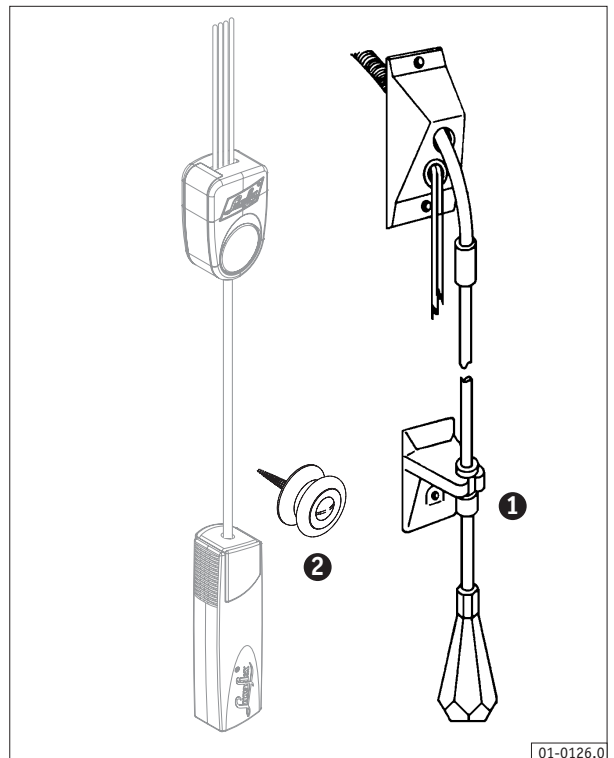

Figure 15.17

15.6 **INSTALLING A TILTMASER BLIND**

- 1 Drill a hole of at least $\varnothing 10$ mm at a distance of approx. 9 mm from the top of the fastening of the head rail.
- 2 Drill a hole of at least $\varnothing 10$ mm at the front of the frame at the position of the control knob.

The cable to be fed through must be at least 150 mm longer than necessary for feeding through.

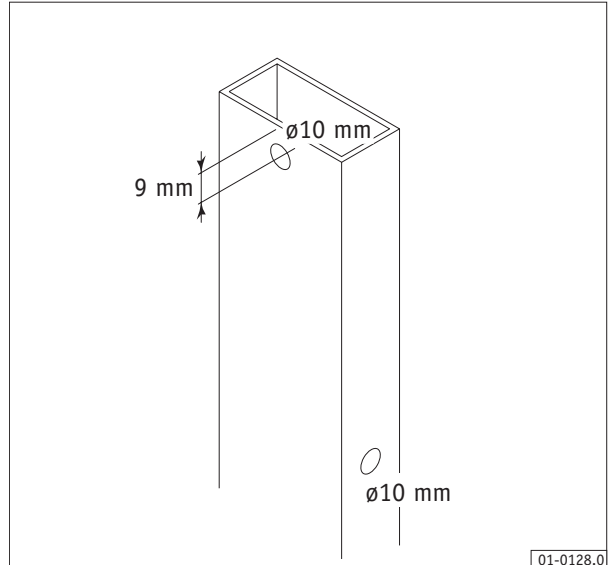

Figure 15.18

- 3 Feed the operating cable through the frame [1].
- 4 Fasten the ring [2].

The attachment must be as close as possible to the support.

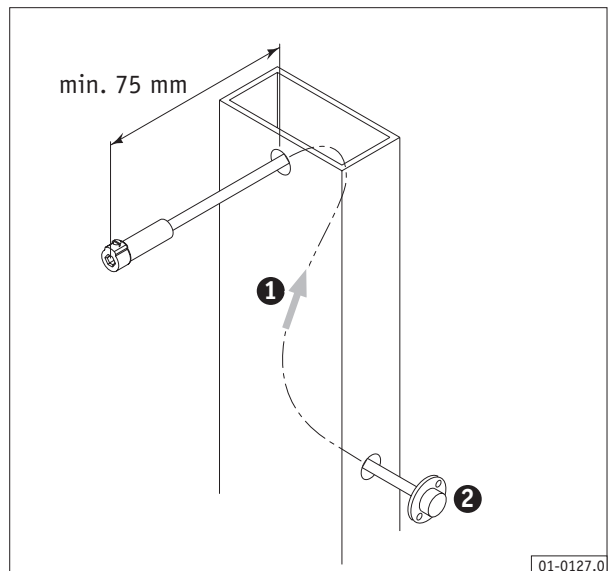

Figure 15.19

- 5 Attach the operating cable to the tilt rod.

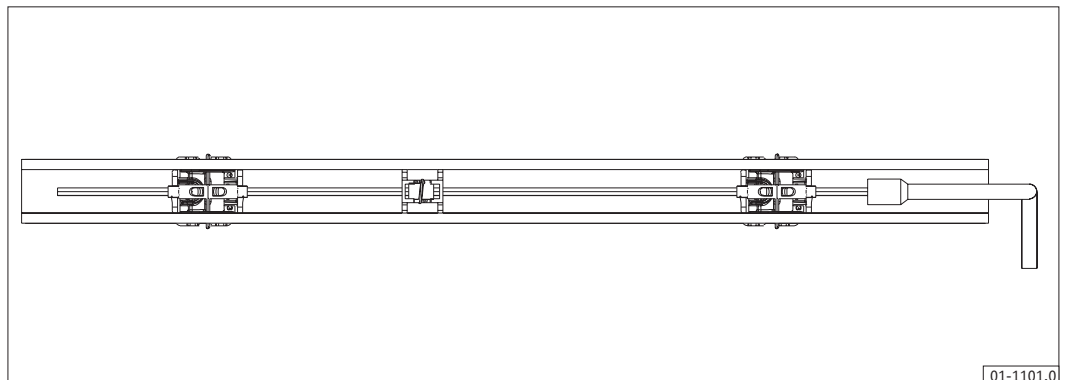

Figure 15.20

- 6 Press the head rail over the brackets.

preliminary

- 7 Attach the control knob to the frame.

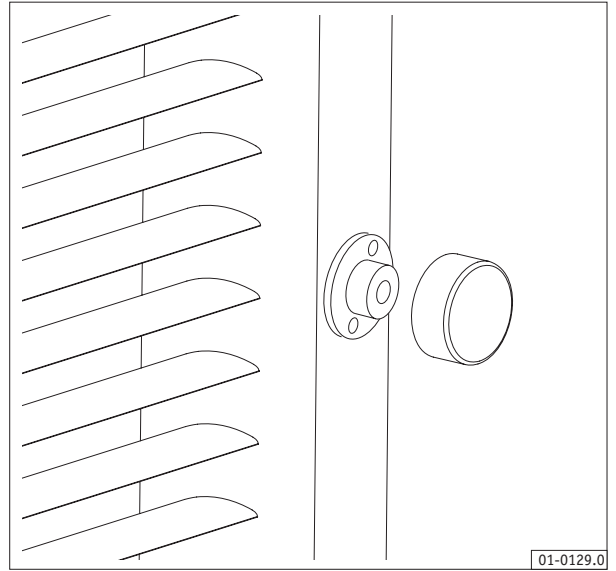

Figure 15.21